



Owner's Manual

Airsled LiftCart®

Covers Models:

Model Name	Model No.	Lift Capacity
LiftCart	ASLC-275	275 lbs.
LiftCart S	ASLC-400	400 lbs.

IMPORTANT – PLEASE READ

This manual includes instructions on proper wiring/power box placement and maintaining awareness of workspace surroundings to prevent damage. Please read these sections carefully prior to using the LiftCart for optimal results.

SPECIFICATIONS

Model Name	Model No.	Weight without casters	Lift Capacity	Table Size	Closed Height without casters	Closed Height with casters	Open Height without casters	Open Height with casters
LiftCart	ASLC-275	51 lbs.	275 lbs.	19.75" x 30"	9"	11.5"	29.25"	31.75"
LiftCart S	ASLC-400	58 lbs.	400 lbs.					

UNPACKING PRECAUTIONS

NOTE: When unpacking, assistance may be required when removing the LiftCart from the box. Ensure the box is on a sturdy surface when unpacking.

CAUTION! When removing the LiftCart from its packaging box, be sure to grip the main frame. Do not just grip the tabletop by the edges. Do not use excessive force if using a sharp, cutting blade when unpacking. There are wires that can be damaged by a sharp, cutting instrument.

IMPORTANT SAFETY INSTRUCTIONS – PLEASE REVIEW

- Do not exceed the stated lift capacity for of your LiftCart model.
- Use only on flat, level, and hard surface capable of supporting the LiftCart and any item(s) placed on the table. Evenly distribute load on the table to avoid tipping especially when using the LiftCart with caster wheels.
- Use as intended only. Do not use LiftCart to lift or transport animals, pets, or people.
- Assemble only according to these instructions. Improper assembly can create hazards.
- Follow all instructions specified in this manual.
- When using, keep work area clean and well lit. Ensure flooring is free of obstructions and debris when moving the LiftCart using the included caster wheels.
- Ensure are wires and the power box are located **UNDER the frame** when using.
- This product is not a toy. Do not allow children to play with or near this item.
- Inspect before every use; do not use if parts are loose or damaged.
- Maintain product labels and nameplates. These carry important safety information. If unreadable or missing, contact Airsled for a replacement.
- Use extreme caution when moving things when the LiftCart is in the fully open position, as a higher center of gravity can lead to risk of tipping. Airsled recommends to only move loads using the LiftCart when the LiftCart is in the fully closed position.
- Keep this product away from water or damp environments to prevent risk of electric shock.

ASSEMBLY INSTRUCTIONS

- The LiftCart comes fully assembled. However, you may wish to install the included caster wheels to the frame.



Use the included wingnut to hand-tighten each caster wheel to the frame.

CONNECTING THE CONTROLS: LIFT CART MODEL ASLC-275

- For LiftCart model ASLC-275, please follow the below steps to properly connect the unit's cables.



When connecting the power box and hand controller, all wiring must run DOWN and UNDER the frame. Otherwise, you risk shearing the wires when raising and/or lowering the LiftCart



Step 1: Lay the LiftCart on its side to properly align the wires completely under the frame.



Step 2: Connect the power box and hand controller wires with those from the linear actuator.



Step 3: Secure the wire connections with the clasp mechanisms.



Step 4: Place LiftCart on its base or caster wheels and confirm all wires run **UNDER THE FRAME**.

- Images below illustrate the CORRECT and INCORRECT placement of LiftCart wiring.



CORRECT WIRE PLACEMENT: Wires completely under the frame. No risk of wires being pinched and possibly sheared during operation.

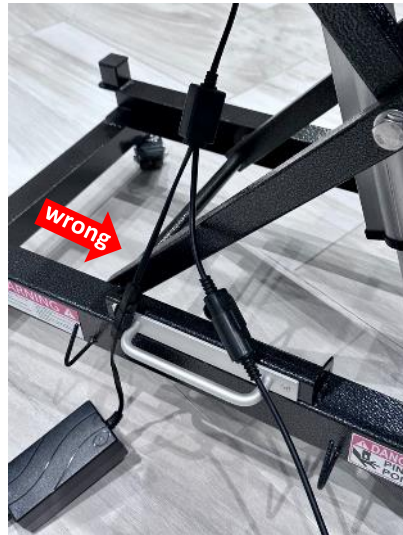

INCORRECT WIRE PLACEMENT: Wires cross over the frame. High risk of wires being pinched and possibly sheared during operation.



INCORRECT WIRE PLACEMENT: Wires cross over the frame. High risk of wires being pinched and possibly sheared during operation.



INCORRECT WIRE PLACEMENT: Wires cross over the frame. High risk of wires being pinched and possibly sheared during operation.

WIRE MANAGEMENT SYSTEM ON THE LIFTCART MODEL ASLC-275

- LiftCart model ASLC-275 comes with a wire management system to help store the electrical components and wiring for the unit is unplugged.
- The images below demonstrate how to properly use the wire management system.



Secure power box in cradle by tightening wing nuts.



Wires and hand controller wrapped around prongs.

CONNECTING THE CONTROLS: LIFTCART S MODEL ASLC-400

- Follow the same wiring guidance as for LiftCart model S ASLC-400 to ensure all wires pass **UNDER THE FRAME** when they are connected.
- LiftCart S model ASLC-400 has slightly different requirements for properly connecting the power box and includes a specially designed key to open the power box.



Step 1: Lay the LiftCart S on its side to properly align the wires completely under the frame.



Step 2: Connect the power box so that the wire is secured into the **LEFT** slot and travels out through the side notch (see red circle over side notch).



Step 3: Connect the hand controller into the lower right slot by pressing it firmly (see red circle).



Step 4: Close the control box by pressing firmly.

- A key is required to release the closure tabs on the control box. Follow the steps below.



Access points to closure tabs.



Step 1: Insert key into access points.

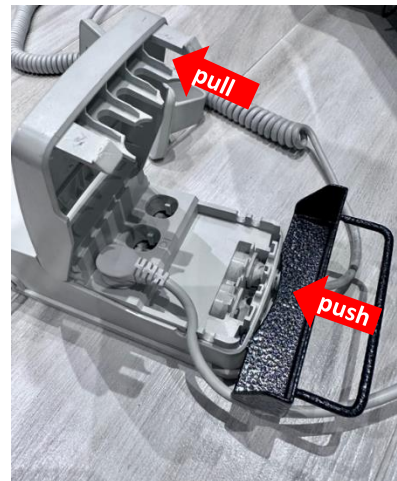

Step 2: Push the key forward and pull the lid up to open.

WIRE MANAGEMENT SYSTEM ON THE LIFTCART S MODEL ASLC-400

- LiftCart S model ASLC-400 comes with the identical prongs to manage the wires and electrical components when the unit is unplugged but has a different mechanism for securing the power box.
- The images below demonstrate how to properly use the power box storage mechanism.



Control box attachment tab mounted to LiftCart S frame.

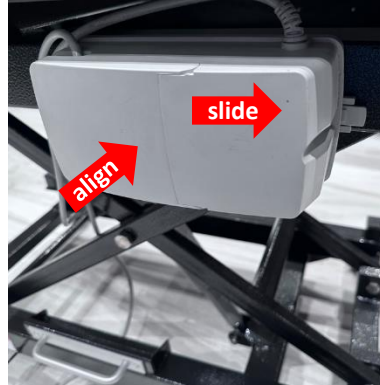

To Attach: Align the control box to attachment tab, press and slide to the right.

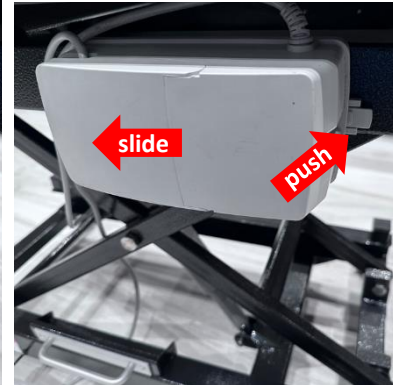

To Remove: Push the release tab and slide the control box to the left.

IMPORTANT SAFETY CONSIDERATIONS WHEN OPERATING THE LIFTCART

- When operating your LiftCart in either a stationary manner or with the caster wheels installed, follow these safety recommendation and considerations.

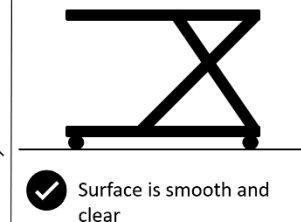
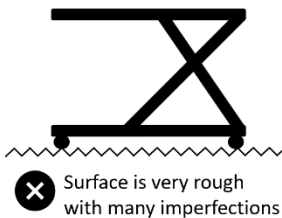
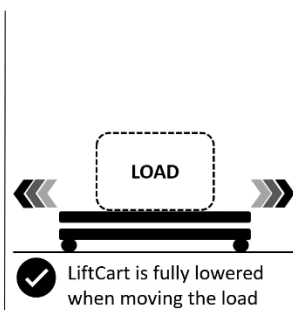
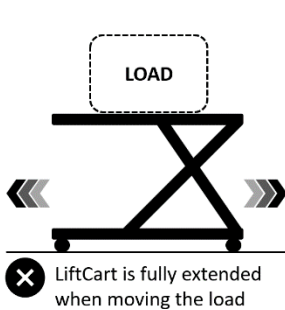
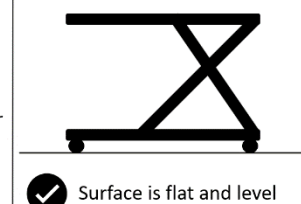
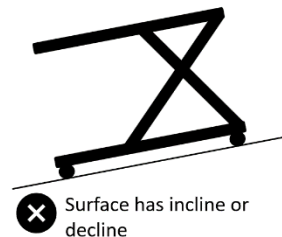
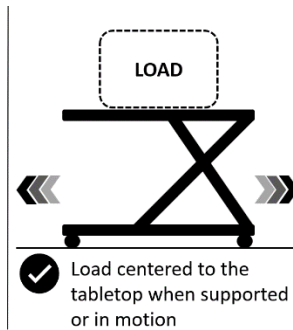
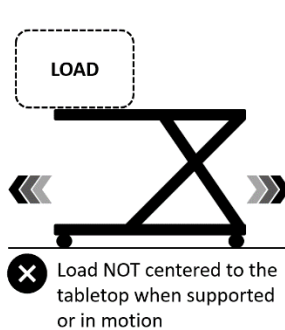

AWARENESS OF WORKSPACE SURROUNDINGS

- When operating the LiftCart, awareness of your workspace surroundings is critical because line of sight may be impacted which can lead to injury and/or damage when lifting or lowering a load.
- This example moving a microwave drawer helps demonstrate the importance of workspace surroundings awareness.



This microwave has a drawer beneath it with a pull handle.



INCORRECT POSITION: Because there is no gap between front of tabletop and drawer pull, the tabletop will run into drawer pull when rising and may cause damage.



CORRECT POSITION: By leaving a gap between the front of the tabletop and the drawer pull, the tabletop will avoid the drawer pull when rising.



The microwave is pulled out until it is over the LiftCart's tabletop's edge. Notice the **safety gap** to the drawer pull.



The tabletop is safely raised to the microwave's base without running into the drawer pull because of the safety gap.



With the tabletop in place, the microwave is pulled out of the cavity.



With the microwave resting on the tabletop, it can be safely moved away from the cabinet.

TABLETOP SAFETY RAILS

The LiftCart has integrated safety rails along the 19.75" long tabletop edges. These rails will help prevent loads being slid onto the tabletop from possibly shifting and falling off the surface.

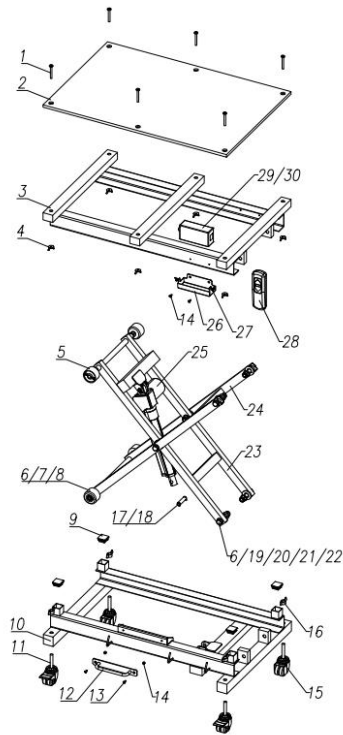

PARTS DIAGRAM: LiftCart model ASLC-275

No.	Part No.	Part Name	Qty
1	ASLC-0001	M6x50 Bolt	6
2	ASLC-0002	Top Platform	1
3	ASLC-0003	Top Metal Frame	1
4	ASLC-0004	M6 Butterfly Nut	6
5	ASLC-0005	Roller A Assembly with Side Rolling Ball	2
6	ASLC-0006	M12 Lock Nut	10
7	ASLC-0007	Nylon Roller	2
8	ASLC-0008	6001-ZZ Ball Bearing	4
9	ASLC-0009	Black Plastic Tube Cap	4
10	ASLC-0010	Cart Chassis	1
11	ASLC-0011	1.5" Heavy Duty Double Caster w/ Brake	2
12	ASLC-0012	Aluminum Carry Handle	1
13	ASLC-0013	M4x12 Countersunk Screw	4
14	ASLC-0014	M4 Lock Nut	2
15	ASLC-0015	1.5" Heavy Duty Double Caster w/o Brake	2
16	ASLC-0016	M6 Butterfly Nut	4
17	ASLC-0017	M12 Shaft	2
18	ASLC-0018	C Shaped Shaft Clip	4
19	ASLC-0019	M12x65 Bolt	6
20	ASLC-0020	M12 Washer	12
21	ASLC-0021	5mm Nylon Washer	6
22	ASLC-0022	12mm White Decoration Bolt Cap	6
23	ASLC-0023	Driving Arm	1
24	ASLC-0024	Auxiliary Arm	1
25	ASLC-0025	Linear Actuator A	2
26	ASLC-0026	Power Box A Holder	2
27	ASLC-0027	M4 Butterfly Nut	2
28	ASLC-0028	Manual Control A	1
29	ASLC-0029	Power Box A	1
30	ASLC-0030	Power Cable	1

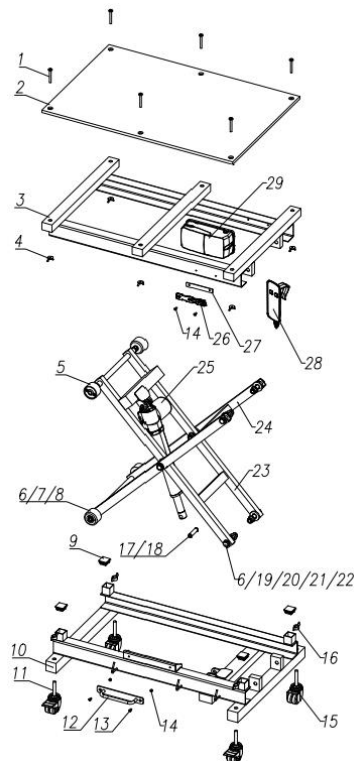
PARTS DIAGRAM: LiftCart S model ASLC-400

No.	Part No.	Part Name	Qty
1	ASLC-0001	M6x50 Bolt	6
2	ASLC-0002	Top Platform	1
3	ASLC-0031	Top Metal Frame	1
4	ASLC-0004	M6 Butterfly Nut	6
5	ASLC-0005	Roller A Assembly with Side Rolling Ball	2
6	ASLC-0006	M12 Lock Nut	10
7	ASLC-0007	Nylon Roller	2
8	ASLC-0008	6001-ZZ Ball Bearing	4
9	ASLC-0009	Black Plastic Tube Cap	4
10	ASLC-0032	Cart Chassis	1
11	ASLC-0011	1.5" Heavy Duty Double Caster w/ Brake	2
12	ASLC-0012	Aluminum Carry Handle	1
13	ASLC-0013	M4x12 Countersunk Screw	4
14	ASLC-0014	M4 Lock Nut	2
15	ASLC-0015	1.5" Heavy Duty Double Caster w/o Brake	2
16	ASLC-0016	M6 Butterfly Nut	4
17	ASLC-0017	M12 Shaft	2
18	ASLC-0018	C Shaped Shaft Clip	4
19	ASLC-0019	M12x65 Bolt	6
20	ASLC-0020	M12 Washer	12
21	ASLC-0021	5mm Nylon Washer	6
22	ASLC-0022	12mm White Decoration Bolt Cap	6
23	ASLC-0033	Driving Arm	1
24	ASLC-0034	Auxiliary Arm	1
25	ASLC-0035	Linear Actuator B	2
26	ASLC-0036	Power Box A Holder	2
27	ASLC-0037	Power Box A Holder Reinforcement Strip	1
28	ASLC-0038	Manual Control B	1
29	ASLC-0039	Power Box B Assembly w/ Power Cable Included	1

PLEASE READ THE FOLLOWING CAREFULLY

THE MANUFACTURER AND/OR DISTRIBUTOR HAS PROVIDED THE PARTS LIST AND ASSEMBLY DIAGRAM IN THIS DOCUMENT AS A REFERENCE TOOL ONLY. NEITHER THE MANUFACTURER OR DISTRIBUTOR MAKES ANY REPRESENTATION OR WARRANTY OF ANY KIND TO THE BUYER THAT HE OR SHE IS QUALIFIED TO MAKE ANY REPAIRS TO THE PRODUCT, OR THAT HE OR SHE IS QUALIFIED TO REPLACE ANY PARTS OF THE PRODUCT. IN FACT, THE MANUFACTURER AND/OR DISTRIBUTOR EXPRESSLY STATES THAT ALL REPAIRS AND PARTS REPLACEMENTS SHOULD BE UNDERTAKEN BY CERTIFIED AND LICENSED TECHNICIANS, AND NOT BY THE BUYER. THE BUYER ASSUMES ALL RISK AND LIABILITY ARISING OUT OF HIS OR HER REPAIRS TO THE ORIGINAL PRODUCT OR REPLACEMENT PARTS THERETO OR ARISING OUT OF HIS OR HER INSTALLATION OF REPLACEMENT PARTS THERETO.

Note: Some parts are listed and shown for illustration purposes only and are not available individually as replacement parts.

LIMITED PRODUCT WARRANTY

Airsled, Inc. (warrantor) uses the utmost care in the design and manufacturing of its products, and this is warranted to be free from defects in material and workmanship, subject to the following limitations, qualifications and conditions.

IDENTITY OF PARTY COVERED BY WARRANTY

This warranty extends only to the first customer purchaser and not to any subsequent transferee.

DESCRIPTION AND IDENTIFICATION OF PRODUCT

This warranty covers the following products of the warrantor; Airsled LiftCart.

WARRANTY STATEMENT

Airsled, Inc. (warrantor) offers a thirty-day money back satisfaction warranty from the date of purchase, excluding all shipping costs. In the event of a defect, malfunction or failure to conform to this warranty, the warrantor, at its election, will replace or repair such merchandise, including parts and labor, the warrantor shall provide return labels. Defects, malfunctions, failure or damage to the product caused by improper unreasonable or negligent abuse are specifically excluded from this warranty. In the event any repair or modification is done to this product during the term of the warranty by anyone other than the Warrantor, the defect applicable to such repair or modification shall be specifically excluded from this warranty, and Warrantor, in its sole operation, may determine if this exclusion shall be applicable. This warranty shall not apply to expendable parts, filters and the finish of painted parts. If products are returned within the 30-day period with visible signs of heavy usage and/or damage, Airsled reserves the right to withhold 15% of the purchase price to cover repair and refurbishment costs.

TERM OF WARRANTY

This warranty shall extend for a period of one (1) year from the date of original purchase by the first consumer purchaser but shall expire prior thereto if the same shall be transferred to another person.

TO OBTAIN PERFORMANCE OF WARRANTY

To obtain performance of this warranty obligation, the eligible consumer must deliver the defective product, with shipping and delivery charges prepaid, to:

**Airsled, Inc.
66 Albe Dr.
Newark, DE 19702
Attn: Customer Service Dept.**

The eligible consumer should also provide satisfactory evidence of the purchase date. In the event the defect involves a not too labor intensive or costly correction, the warrantor shall replace or repair the product and return the same to the consumer, with all return shipping and delivery charges prepaid.

LIMITATION ON REFUND

The Warrantor reserves the right to elect a refund in lieu of repair or replacement of the product provided the Warrantor is unable to provide replacement and repair is not commercially practical or cannot be timely made.

EXCLUSION OF ALL OTHER WARRANTIES

Other than as expressly provided herein, warrantor makes no other warranty express or implied with respect to the product sold. Warrantor makes no warranty of product merchantability and no warranty of fitness of the product for a particular purpose.

EXCLUSION OF INCIDENTAL OR CONSEQUENTIAL DAMAGES

This warranty extends only to repair or replacement of the product and does not afford any coverage with respect to incidental or consequential damages, nor shall any claim be greater in amount than the purchase price of the product to which such claim is made. (Some states do not allow the exclusion or limitation of the incidental or consequential damages so that the above limitation or exclusion may not apply to you.)

ADDITIONAL RIGHTS

This warranty gives you specific legal rights and you may also have other rights which vary from state to state.

AIRSLED, INC.

This warranty is intended to comply with Federal Legislation relating to the contents and terminology in all warranties and shall be construed in a manner of consistent therewith.