

Airsled Appliance Dolly Model AD450

AIRSLED[®]
POWERFUL | PORTABLE | POSSIBLE

Safety Warnings

1. Use only as described in this manual. Use only the manufacturer's recommended attachments and/or accessories.
2. DO NOT use with any load that exceeds this product's weight rating of 450 lbs.
3. DO NOT place the product on uneven or soft ground.
4. This product is not intended for use by persons (including children) with reduced physical, sensory or mental capabilities, or lack of experience and knowledge, unless they have been given supervision or instruction concerning use of the product by a person responsible for their safety.
5. DO NOT modify or pair without the guidance of Airsled.
6. When moving heavier loads on delicate or some softer wood floors, we suggest the use of a protective material over the work area.

Parts List

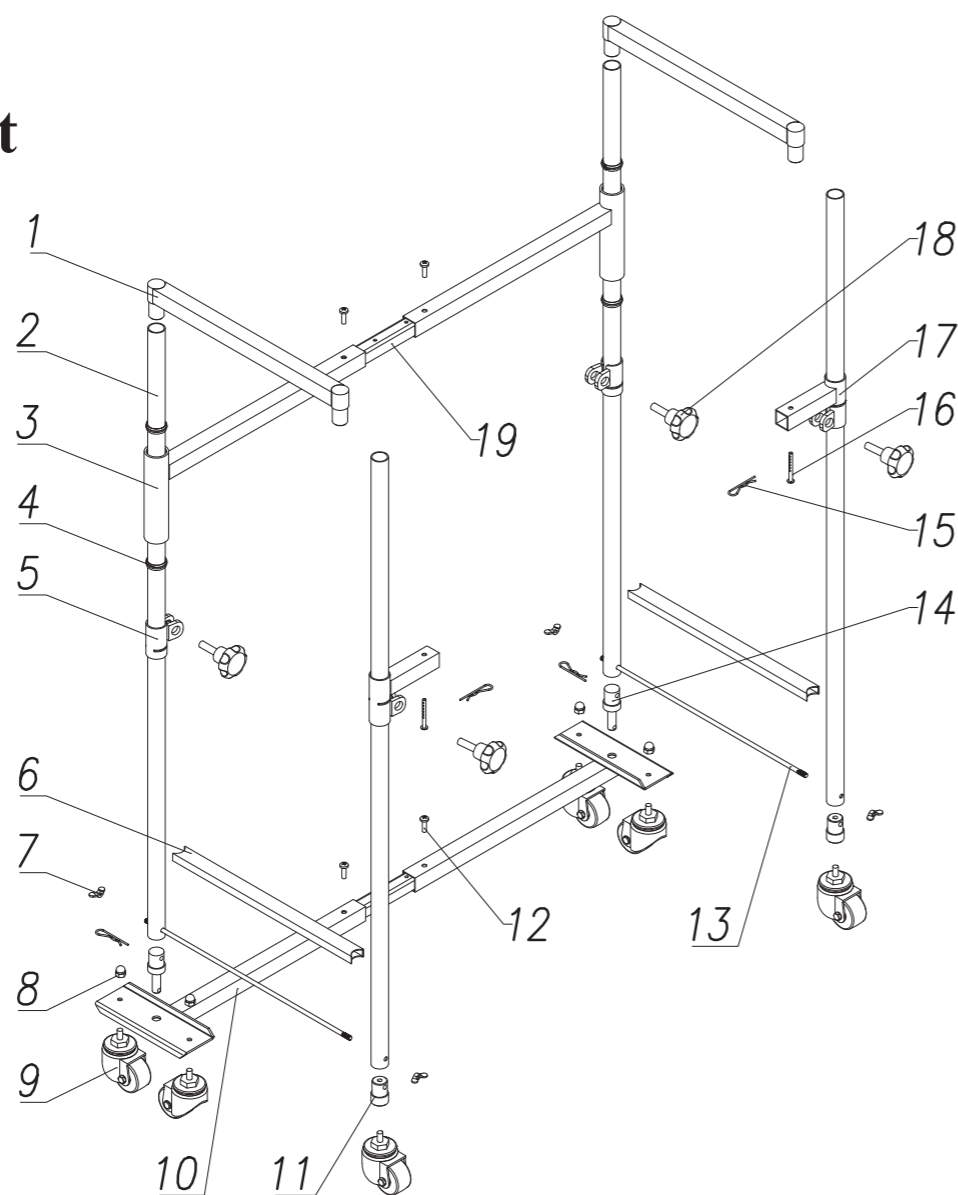

Part No.	Part Name	Quantity	No.	Part Name	Quantity
AD01	Top connecting rail	2	AD11	Pipe pivot for caster	2
AD02	Upright pipe	4	AD12	M6*20 Phillips Pan head bolt	4
AD03	Pipe sleeve with top beam	2	AD13	Double-threaded-end rod	2
AD04	Plastic holder	4	AD14	Pipe pivot for base	2
AD05	Tightener for pipe sleeve	2	AD15	R clip	4
AD06	Bottom connecting rail	2	AD16	Adjustable Clevis pin	2
AD07	M6 Butterfly nut	4	AD17	Pipe sleeve with tightener	2
AD08	M8 Acorn nut	4	AD18	M10*35 Knob	4
AD09	2" caster with M8*15 bolt	6	AD19	Beam/Base connector	2
AD10	Base with two casters	2			

Assembly Instructions

1. Put the Plastic holder into the groove of the Pipe sleeve with top beam.
2. Put the Beam/Base connector into the beam of the Pipe sleeve with top beam and fix with M6*20 Phillips Pan head bolt without tightening.
3. Use M8 Acorn nut to install the 2" caster with M8*15 bolt onto the two small side holes on one end of Base with two casters. Put the Beam/Base connector into the beam of the Base with two casters and fix with M6*20 Phillips Pan head bolt without tightening.
4. Put the small end, with a hole, of Pipe pivot for base, through the one middle hole on one end of the Base with two casters. Use R clip to fix the hole on the small end of Pipe pivot for base.
5. Screw the 2" caster with M8*15 bolt to the Pipe pivot for caster.
6. Put the Tightener for pipe sleeve on to an Upright pipe. Align the holes of the Pipe pivot for caster and of the Upright pipe. Align the holes of the Pipe pivot for base and of another Upright pipe.
7. Put a Double-threaded-end rod through the holes of a Upright pipe & Pipe pivot for base, a Bottom connecting rail, and a Upright pipe & Pipe pivot for caster, and then fix the two ends of the rods with M6 Butterfly nuts.
8. Put the Pipe sleeve with top beam onto the Upright pipe on the Base with two casters. Take note to place Beam with label facing away.
9. Put the Pipe sleeve with tightener onto the Upright pipe on the 2" caster. Use an M10*35 Knob to tighten, put an Adjustable clevis pin into the hole of the Pipe sleeve and fix with an R clip.
10. Install the Top connecting rail on the top of the Upright pipes.
11. Use an M10*35 Knob to tighten the Tightener for pipe sleeve, and tighten M6*20 Phillips Pan head bolts on the Beam/Base connectors.

Maintenance

In between use, the product should be cleaned with a soft cloth or sponge using a mild cleaning agent. Components that pivot come pre-greased but if they become stiff or noisy, spray with WD40 or similar product. The moving parts of the product should be periodically lubricated to ensure the smoothness of the movement.

Service and Support

For customer service or technical support, please contact us at:
Address: Airsled, Inc. 66 Albe Dr. Newark, DE 19702
Phone: 1-800-AIRSLED (1-800-247-7533)
Email: airsled@airsled.com
Website: www.airsled.com